

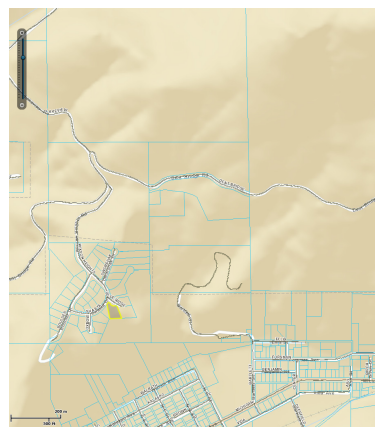

Today's Date: 05/09/2017
Parcel ID: RPA1610002008/



Owner Information

Owner(s):

Owner Name	Parcel Type
TEED, FAYE A	RP

Mailing Address:

240 BLUE RIDGE CT
OROFINO, ID 83544

Property Address:

240 BLUE RIDGE CT
OROFINO
83544

Legal Description:

OROFINO WIXSON HEIGHTS SUBD
SEC 6 36N 2E
LOT 8, BLK 2 & PT LOT 7
& TAX # 3303 IN LOT 9, BLK 2

Document Reference:

1: 192187
2:
3:
4:
5:

Tax Information

Values:

Tax Year	Tax Amt.	Imps. Value	Land Value	Net Value
2014	1417.04	88890	36832	62861

Tax Code Area #: 10000

Ambulance: Clearwater County Ambulance	City:
Library: Clearwater Free Public Library	Cemetery:
Recreation: Weippe Fraser Recreation District	School: Joint School District 171
Water/Sewer:	Highway: Clearwater Highway District
Fire: Weippe Rural Fire District	Center:

Assessor Information:

Review Year: 2012

Rev. Year	Category	Rec#	Quantity	Units	Value	Exempt	Net
2012	20	1	0.48	AC	36832	18416	18416
2012	41	1	0		89120	44560	44560

Totals:			0.48		125952	62976	62976
----------------	--	--	------	--	--------	-------	-------