

Esri User Conference

Attendee Guide

July 10–14, 2017 | San Diego, CA
San Diego Convention Center



Your Guide to the 2017 Esri User Conference

Esri Events App

Easily access all Esri User Conference (Esri UC) information in real time, including agendas and session descriptions. You can even create a personalized schedule to optimize your experience.

You can now download and print the full Esri UC agenda—or your personally-customized agenda—from the Agenda page on the Esri UC website.

Download the Events App

[Apple Store](#)

<https://tinyurl.com/yatvx3h5>



[Google Play](#)

<https://tinyurl.com/y8kjrzap>

Registration and Badge Pickup

Checking in is fast and easy! Bring your photo ID and Esri UC registration confirmation—or have it available on your mobile device. Scan the bar code to quickly and easily obtain your Esri UC badge and start your week!

San Diego Convention Center, Hall D

Saturday, July 8 | 7:30 a.m.–5:00 p.m.

Sunday, July 9 | 7:30 a.m.–5:30 p.m.

Monday, July 10 | 7:00 a.m.–5:00 p.m.

Tuesday, July 11 | 7:30 a.m.–5:00 p.m.

Wednesday, July 12 | 7:30 a.m.–5:00 p.m.

Thursday, July 13 | 7:30 a.m.–3:00 p.m.

Hilton San Diego Bayfront Hotel, Indigo Foyer, Level 2

Friday, July 7 | 4:30 p.m.–7:00 p.m.

Saturday, July 8 | 7:30 a.m.–5:00 p.m.

Sunday, July 9 | 7:30 a.m.–5:00 p.m.

Monday, July 10 | 7:00 a.m.–9:30 a.m.

San Diego Marriott Marquis & Marina Hotel, Marina Foyer—South Tower, Level 3

Saturday, July 8 | 7:30 a.m.–5:00 p.m.

Sunday, July 9 | 7:30 a.m.–4:30 p.m.

Manchester Grand Hyatt Hotel, Grand Ballroom Foyer

Saturday, July 8 | 7:30 a.m.–5:00 p.m.

Sunday, July 9 | 7:30 a.m.–4:30 p.m.





DISCOVER Esri's Best GIS Resources

This year at UC, we're providing digital access to the best GIS resources for continued insight and inspiration, whenever and wherever you want. DISCOVER, share, and access best practices, webinar series, training, use case examples, and so much more—by just tapping your badge. Throughout the EXPO hall, locate a DISCOVERY Tag and simply tap your badge to be emailed resources for that specific topic or area. The latest and greatest resources are just a tap away!

New Attendee Orientation

Join other first timers get a comprehensive overview of the conference to help you plan your schedule and take advantage of all that the Esri UC has to offer.

Sunday, July 9 | 4:00 p.m.–5:30 p.m.

San Diego Convention Center, Ballroom 20 A

Opening Plenary Session

Join Esri president Jack Dangermond to learn what's new and next in GIS technology.

Hear how today's GIS thought leaders are changing the world by applying The Science of Where™.

Monday, July 10 | 8:30 a.m.–3:30 p.m.

San Diego Convention Center, Exhibit Halls F–H

Map Gallery Opening and Reception

Enjoy hors d'oeuvres, drinks, and stimulating conversation as you explore how your peers map their world with GIS technology.

Monday, July 10 | 3:30 p.m.–7:00 p.m.

San Diego Convention Center, Sail Area

The Esri UC GIS Solutions Expo

This is the place to explore, learn, and find true inspiration by connecting one-on-one with GIS innovators from the user community, Esri staff, and other Esri partners.

Tuesday, July 11–Wednesday, July 12 | 9:00 a.m.–6:00 p.m.

Thursday, July 13 | 9:00 a.m.–1:30 p.m.

San Diego Convention Center, Exhibit Halls A–C





The Esri UC Store

Shop for all things GIS at the Esri UC Store, which has the latest and greatest apparel, accessories, and more!

Sunday, July 9 | noon–6:00 p.m.

Monday, July 10–Thursday, July 13 | 8:00 a.m.–6:00 p.m.
San Diego Convention Center, Grand Lobby

Friday, July 14 | 8:00 a.m.–noon

San Diego Convention Center, Ballroom 20 Lobby

Esri UC Activities

Find your work-life balance by supplementing your conference agenda with fun activities that exercise your body and mind.

Esri 5K Fun Run/Walk

Join your fellow attendees along the scenic San Diego waterfront for this chip-timed event.

Wednesday, July 12 | 6:30 a.m.

Hilton San Diego Bayfront Hotel

Please note: Registration and fees apply.

[View the 5K Course Map](#)

<https://tinyurl.com/yanwgq8c>

Morning Yoga

Start your day with a sense of inner calm. Stretch your body and relax your mind during morning yoga overlooking the San Diego Bay.

Tuesday, July 11 and Thursday, July 13 | 6:30 a.m.–7:30 a.m.

Hilton San Diego Bayfront Hotel, Promenade Plaza

Please note: Registration and fees apply.

[Explore the Schedule of Activities](#)

esri.com/about/events/uc/things-to-do/health-fitness

Family Night

Introduce your family and friends to GIS. Explore partner exhibits and enjoy fun activities, food, and drinks.

Wednesday, July 12 | 4:00 p.m.–6:00 p.m.

Located in the Esri UC GIS Solutions Expo
San Diego Convention Center, Exhibit Halls A–C





Kids Fair

Enjoy age-focused stations that include activity booths, a hands-on computer lab, and a demonstration theater. The Kids Fair is ideal for children aged 5–15 and is free and open to everyone.

Please note: Children must be accompanied by a parent or guardian.

Tuesday, July 11 | 9:00 a.m.–5:00 p.m.

Wednesday, July 12 | 9:00 a.m.–4:00 p.m.

Thursday, July 13 | 9:00 a.m.–2:00 p.m.

San Diego Marriott Marquis and Marina—Marina Ballroom, Salon D

KiddieCorp

Esri's trusted partner, KiddieCorp, provides a childcare program for children aged 6 months through 12 years.

Monday, July 10–Thursday, July 13 | 8:00 a.m.–5:30 p.m.

San Diego Marriott Marquis and Marina—Leucadia/Oceanside

Please note: Registration and fees apply.

[Get Detailed Information](https://form.jotform.com/KiddieCorp/esrikids)

<https://form.jotform.com/KiddieCorp/esrikids>



Thursday Night Party

Join thousands of your colleagues in San Diego's Balboa Park. Enjoy great food, awesome entertainment, and fun activities for the whole family.

Wristbands are required. Don't forget to pick up yours by scanning your badge on Wednesday or Thursday at the Activities Desk or Information Desk in Grand Lobby D, San Diego Convention Center.

Additional tickets can be purchased for family and friends at the Activities Desk for \$50 each.

Round trip shuttle transportation will be provided to and from the park from 5:00 p.m. to 10:30 p.m.

Thursday, July 13 | 5:30 p.m.–10:00 p.m.
Balboa Park

Food Trucks

Enjoy a wide variety of delicious food with your peers at the park overlooking the San Diego Bay.

Monday, July 10 | noon–2:00 p.m.

Tuesday, July 11–Thursday, July 13 | 11:30 a.m.–1:30 p.m.
Hilton San Diego Bayfront Hotel Lawn



Restaurant Discounts

Take advantage of special discounts at downtown San Diego restaurants, exclusively for Esri UC attendees. Please check with the Esri UC Information Desk for more details.

Information Desks

Need assistance? We're available to help answer your questions. Just visit one of the information desks located throughout the convention center.

Coat Check

You may securely check your belongings at the San Diego Convention Center, Grand Lobby C.

Parking

On-site private vehicle parking is available at the 1,950-vehicle underground garage located below the San Diego Convention Center.

[Explore Parking Options](https://visitsandiego.com/location/parking)

<https://visitsandiego.com/location/parking>

Charging Your Mobile Device

Be sure to bring your adapters to charge your mobile devices. While charging stations within the San Diego Convention Center are limited and in great demand, electrical outlets are readily available.

Cash Limitation

Please be aware that the ability to use cash to purchase additional registrations, Esri UC activities, items in the Esri UC Store, etc., may be limited. Credit/Debit cards are the preferred form of payment.

Esri GeoNet

Keep the conversation going by signing up for GeoNet, the Esri UC online resource where you can ask questions, provide feedback, get to know other conference attendees, and stay connected throughout the year.

[Join GeoNet](https://geonet.esri.com)

geonet.esri.com/community/events/user-conference

Be Comfortable and Stay Warm

With over 2 million square feet of conference center space, we encourage you to wear comfortable shoes. And given the cool temperatures in the convention center and the evenings outdoors, we also encourage you to bring a light jacket.

esri.com/about/events/uc

GROUND LEVEL VIEW

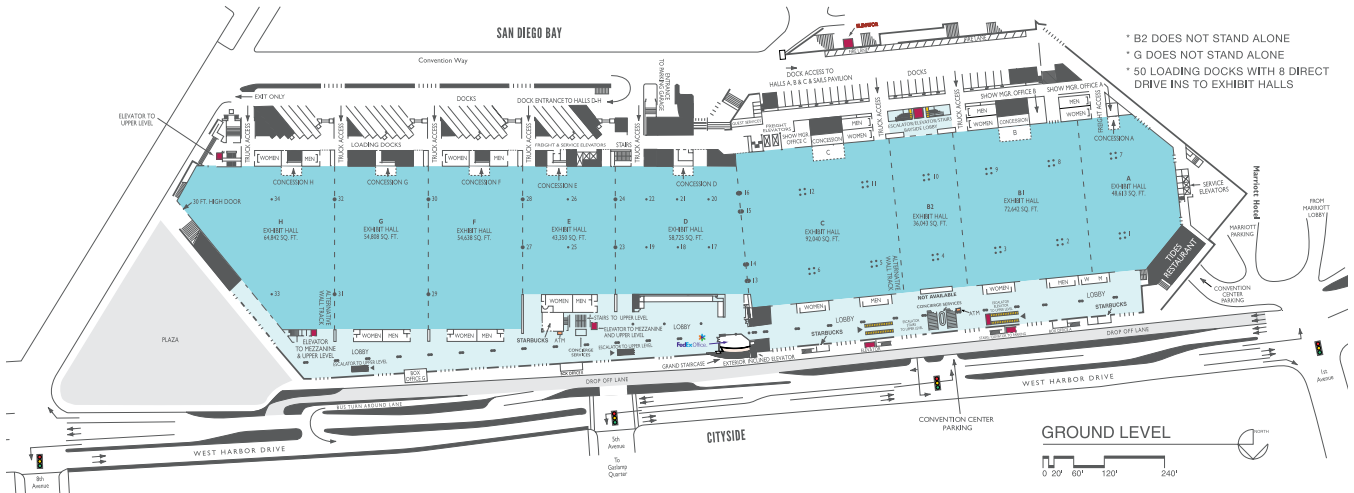

* B2 DOES NOT STAND ALONE
 * G DOES NOT STAND ALONE
 * 50 LOADING DOCKS WITH 8 DIRECT DRIVE INS TO EXHIBIT HALLS

MEZZANINE LEVEL VIEW

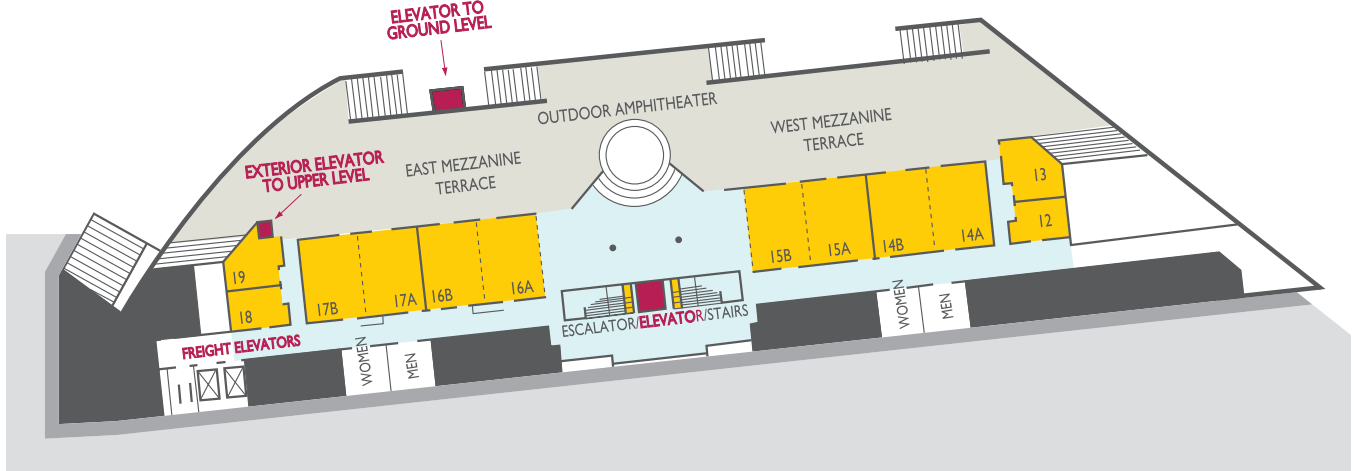

UPPER LEVEL VIEW

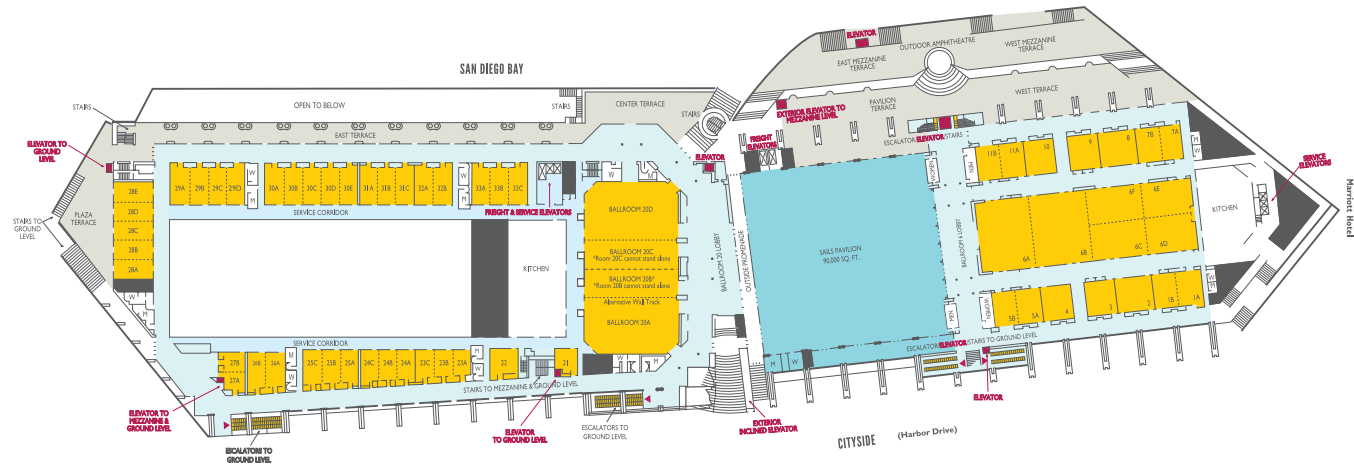



Esri, the global market leader in geographic information system (GIS) software, offers the most powerful mapping and spatial analytics technology available. Since 1969, Esri has helped customers unlock the full potential of data to improve operational and business results. Today, Esri software is deployed in more than 350,000 organizations including the world's largest cities, most national governments, 75 percent of Fortune 500 companies, and more than 7,000 colleges and universities. Esri engineers the most advanced solutions for digital transformation, the Internet of Things (IoT), and location analytics to inform the most authoritative maps in the world.

Visit us at [esri.com](https://www.esri.com).



Contact Esri

380 New York Street
Redlands, California 92373-8100 USA

1 800 447 9778
T 909 793 2853
F 909 793 5953
info@esri.com
[esri.com](https://www.esri.com)

Offices worldwide
[esri.com/locations](https://www.esri.com/locations)